

ADDENDUM NUMBER 2
PROJECT CODE: A0122-21-492426 and A0135-22-511452
IFB# 154542103

November 9, 2021

PROJECT: Virginia Tech
New Baseball Pitching Lab
Blacksburg, Virginia

TO ALL BIDDERS:

GENERAL: Addenda are part of the Contract Documents and are issued to amend or interpret the Drawings and Specifications. **The Addenda shall be acknowledged in the Bid Form** in the space provided for addenda acknowledgement.

Addenda list items by Drawings and Specifications. However, only specification items are referenced to Sections. Drawing changes, as well as Specification changes, described in Addenda shall include all Work required by the various trades involved to effect the changes described.

CHANGES AND CLARIFICATIONS – GENERAL

1. The **Bid Due Date and Time** has been changed to **NOVEMBER 19, 2021 AT 2 P.M.**
2. The **Remote Bid Opening** has been changed to **NOVEMBER 22, 2021 AT 2 P.M.**

CHANGES AND CLARIFICATIONS – PROJECT MANUAL

NONE

CHANGES AND CLARIFICATIONS - DRAWINGS

The following changes shall be clouded and marked with **REVISION NUMBER 2:**

LS1, LIFE SAFETY PLAN & BUILDING CODE DATA:

REVISE reference code year for ICC / ANSI A117.1 (ACCESSIBLE AND USEABLE BUILDINGS AND FACILITIES) from 2017 to **2009**.

A6.2, STOREFRONT TYPES, DOOR SCHEDULE & NOTES:

REVISE STOREFRONT NOTES, paragraph C 2 and C 3 to read:

2. SEALED INSULATED GLASS UNITS (IG): 1" LOW-E CLEAR INSULATED GLASS UNITS, **SOLARBAN 70 ON CLEAR GLASS** BY VITRO ARCHITECTURAL GLASS OR APPROVED EQUAL.
 - a. OUTBOARD LITE: **CLEAR**, ¼", FULLY TEMPERED FLOAT GLASS, W/ LOW-E COATING ON THE #2 SURFACE.
 - b. INBOARD LITE: **CLEAR**, ¼", FULLY TEMPERED FLOAT GLASS.
 - c. VLT: **64 MINIMUM**
 - d. SHGC: **0.27**
3. SEALED INSULATED SPANDREL GLASS UNITS (SG): 1" LOW-E CLEAR INSULATED GLASS UNITS, **SOLARBAN 70 ON CLEAR GLASS** BY VITRO ARCHITECTURAL GLASS AND OPACI-COAT-300 OPACIFIER BY ICD OR APPROVED EQUAL.
 - a. OUTBOARD LITE: **CLEAR**, ¼", FULLY TEMPERED FLOAT GLASS, W/ LOW-E COATING ON THE #2 SURFACE.
 - b. INBOARD LITE: **CLEAR**, ¼", FULLY TEMPERED FLOAT GLASS, W/ OPACIFIER ON THE #4 SURFACE.

- c. COLOR: **2-3548 VALLEY MIST**, BASIS OF DESIGN.

A7.1, PRECAST SCHEDULE:

ADD PRECAST GENERAL NOTE C to read:

- C. THE ARCHITECTURAL PRECAST WALL PANELS SHALL BE DESIGNED TO BE SUPPORTED BY THE MASONRY BACKUP WALL AND SHALL NOT BEAR ON THE HOKIE STONE WATER TABLE. COMPREHENSIVE ENGINEERING DESIGN, BY THE PRECAST SUPPLIER/MANUFACTURER, SHALL BE PROVIDED FOR THE ARCHITECTURAL PRECAST PANELS IN ACCORDANCE WITH THE SPECIFICATIONS (REFERENCE SECTION 034500). THE BENT PLATE SHOWN ON DETAIL 2/A3.4 AND 2/S3.1 IS INTENDED TO ALLOW FOR LATERAL SUPPORT OF THE PRECAST PANELS WHERE NEEDED BY THE DESIGN AND FOR SUPPORT OF THE FLASHING.

P0.1, PLUMBING LEGEND, DETAILS, FIXTURE SCHEDULE AND NOTES:

CLARIFICATION the rim dimension on HANDICAPPED WC ROUGH-IN DETAIL, 16" – 17-1/2" RIM, is to the top of the fixture rim without the seat. The dimension to the top of the seat shall be 17" – 19" as shown on LS1.

P1.1, FLOOR PLANS – PLUMBING:

See attached P1.1 with revisions clouded.

ATTACHMENTS

1. **P1.1, FLOOR PLANS – PLUMBING**
2. **Prebid Questions**

THE BID DUE DATE AND TIME IS NOW NOVEMBER 19, 2021 AT 2 P.M. AND THE REMOTE BID OPENING IS NOW NOVEMBER 22, 2021 AT 2 P.M. ALL OTHER TERMS, CONDITIONS, AND DESCRIPTIONS REMAIN THE SAME.

END OF ADDENDUM NUMBER 2

BID SET
 95% NOT FOR
 CONSTRUCTION

REVISIONS	DATE
2	11-09-2021

FLOOR PLANS - PLUMBING

ADDITION TO JAMES C WEAVER BASEBALL CENTER
 PITCHING LAB &
 WEIGHT ROOM
 BLACKSBURG, VIRGINIA



DATE	10 . 08 . 21
WORK ORDER	A0122-21-492426
SCALE	AS NOTED
DRAWN	MDM/MGW
JOB	2108
SHEET	

P1.1

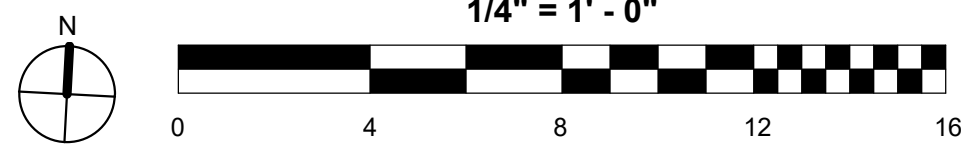
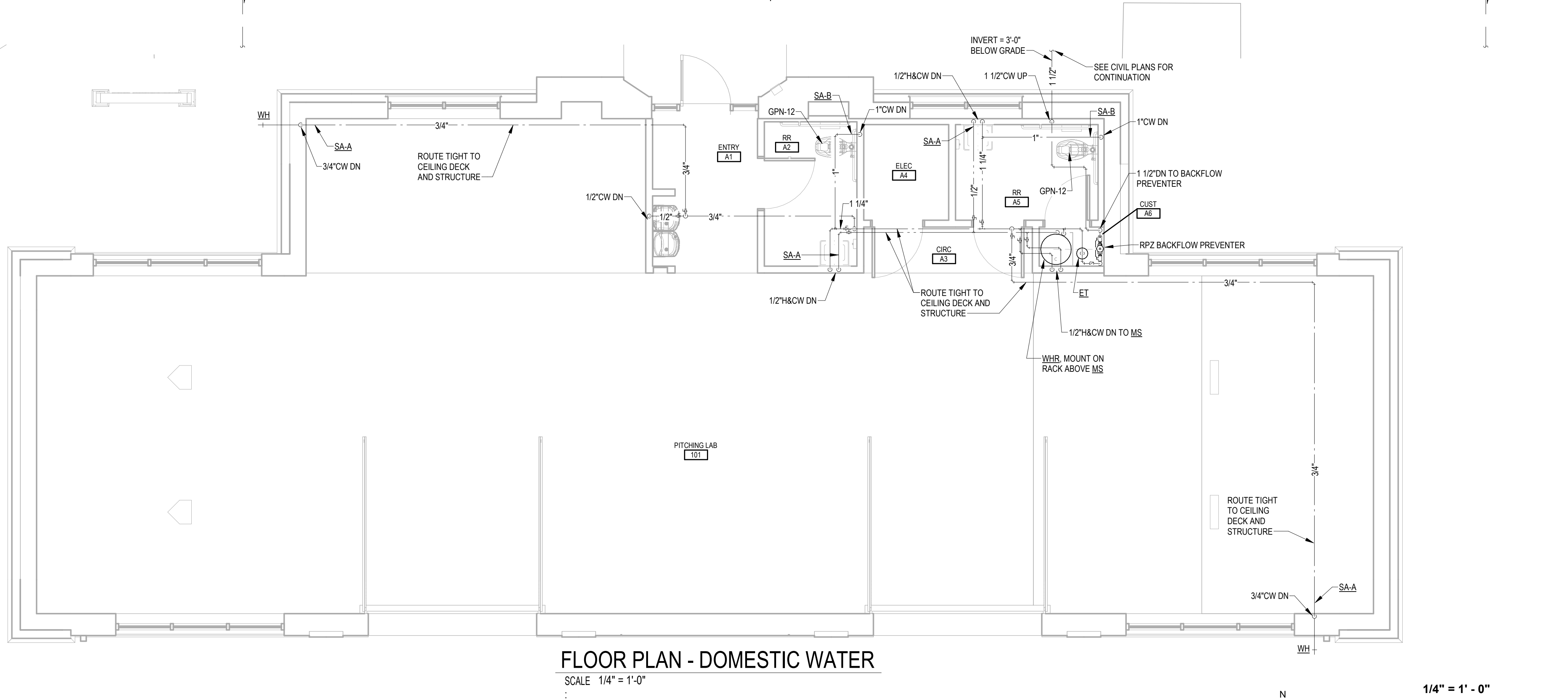
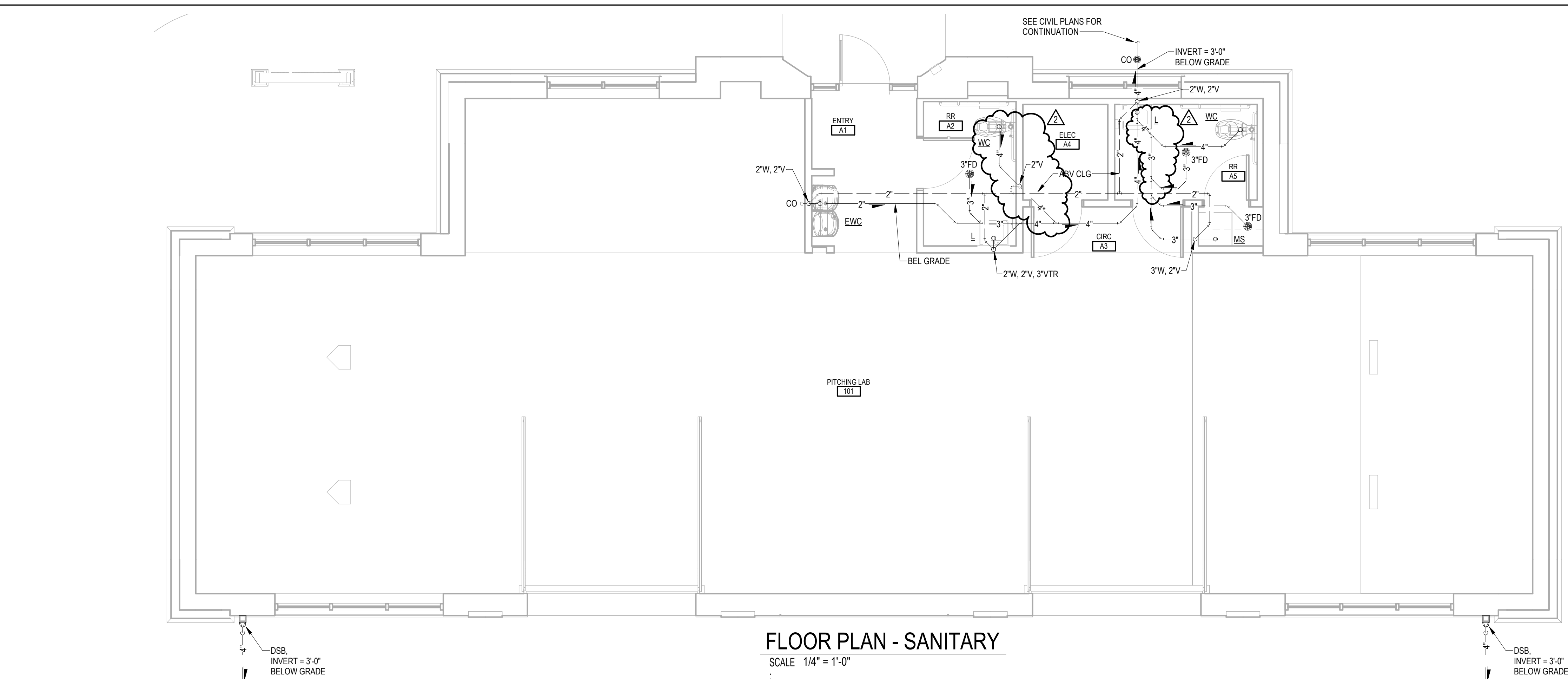

LPA

LAWRENCE PERRY & ASSOCIATES

Consulting Engineers

15 E Salem Avenue SE, Suite 101
 Roanoke, Virginia 24011
 Comm. No.: 20110
 © Lawrence Perry and Associates, Inc.

Ph: (540) 342-1816
 Fax: (540) 344-3410

VIRGINIA TECH UBO APPROVAL

PREBID QUESTION FORM

(Use separate Form for each question submitted.)

Date: November 2, 2021

Project Title: VIRGINIA TECH ATHLETICS, NEW BASEBALL PITCHING LAB

Project Code No.: A0122-21-492426 and A0135-22-511452

The following question concerns Drawing Sheet (number) _____:

Please review the angle size supporting the precast. One of the precast fabricators
feels the angle is not adequate enough.

The following question concerns Specifications Section (number) _____, page _____, paragraph _____:

All responses to questions will be made by Addendum.

Question submitted by:	<u>Jack Bulls</u>	<u>Avis Construction</u>
	<u>Name</u>	<u>Organization</u>

Bidders shall submit form to:	<u>John Spence</u>	<u>Virginia Tech</u>
	<u>Name</u>	<u>Organization</u>

Email address: jspenc@vt.edu

PREBID QUESTION FORM
(Use separate Form for each question submitted.)

Date: 11-8-21

Project Title: **VIRGINIA TECH ATHLETICS, NEW BASEBALL PITCHING LAB**

Project Code No.: A0122-21-492426 and A0135-22-511452

The following question concerns Drawing Sheet (number) One of the precast suppliers :
is concerned with a couple of details ① Detail 200 A3.4
show the water table @ stone. The supplier indicated the hokie stone
cannot support the PC panels, but only the trim items.
② Detail 200 S3.1, the precast supplier indicated the 3/16"
drill plate needs to be changed to a thicker angle to not only
support the flashing but also the PC panels

The following question concerns Specifications Section (number) _____, page _____, paragraph _____:

All responses to questions will be made by Addendum.

Question submitted by: Chris Smith Clark Brothers Company
Name Organization

Bidders shall submit form to: John Spence Virginia Tech
Name Organization

Email address: jspenc@vt.edu