

NOTE: SUPPORT SHELF TO BE ALL WELDED CONSTRUCTION

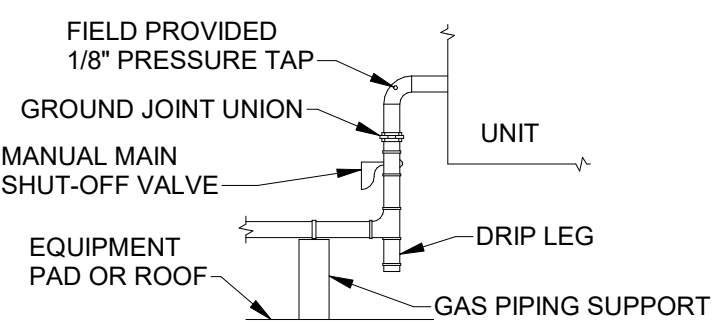
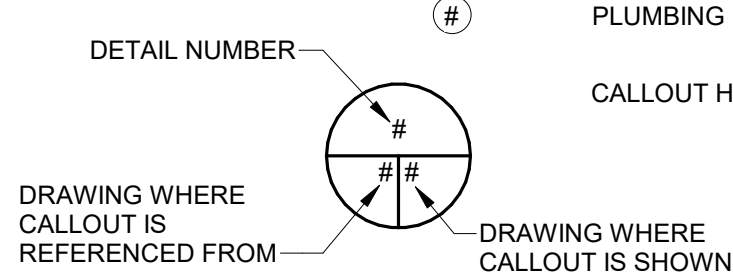
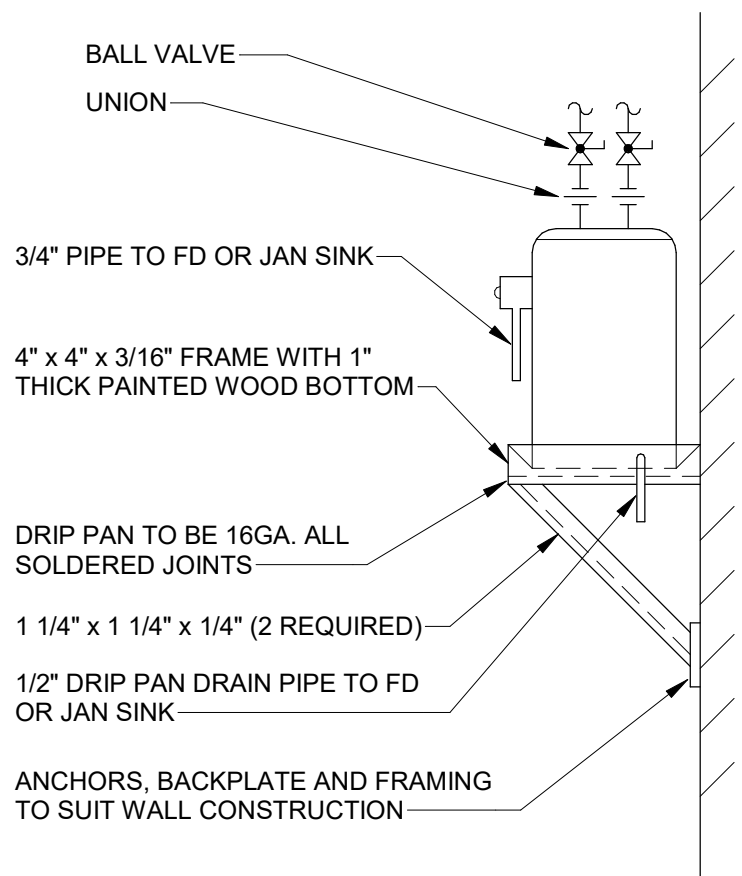

DOMESTIC WATER HEATER DETAIL

NOT TO SCALE

MISCELLANEOUS EQUIPMENT SCHEDULE									
MARK	DESCRIPTION								
DWH-1	DOMESTIC WATER HEATER - BRADFORD WHITE ELECTRIFLEX LD COMMERCIAL LOWBOY MODEL LE120L3-3" WITH 19 GALLON TANK, 1.5 KW NON-SIMULTANEOUS INPUT, 6 GPH RECOVERY AT 100 DEG.F RISE, 120V/1PH/60HZ								
ET-1	THERMAL EXPANSION TANK - AMTROL MODEL ST-5-C WITH 0.9 GALLONS ACCEPTANCE VOLUME.								
FCO	FLOOR CLEANOUT - JOSAM 55000 SERIES. LINE SIZED.								
FD-1	3" FLOOR DRAIN - JOSAM 30000-A SERIES CAST IRON FLOOR DRAIN WITH 1/2" TRAP PRIMER CONNECTION.								
IMB	ICE MAKER CONNECTION BOX - OATEY MODEL I2K LOW LEAD WITH PLASTIC FACEPLATE AND QUARTER-TURN BRASS BALL VALVE.								
PRV-1	PRESSURE REDUCING VALVE - WATTS SERIES LFN223B. PROVIDE WITH LEAD FREE CAST COPPER SILICON ALLOY REGULATOR TO HANDLE LOW DEMANDS AND STAINLESS STEEL STRAINER SCREEN.								
RPZ-1	1 1/2" REDUCED PRESSURE ZONE ASSEMBLY - WATTS MODEL LF909M1-QT 1 1/2. PROVIDE WITH AIR GAP, QUARTER-TURN BALL VALVES, AND STRAINER.								
TMV-1	THERMOSTATIC MIXING VALVE: LEONARD MODEL TM-26-LF WITH 3/4" INLETS AND OUTLET. INSTALL AT POINT OF USE AT LAVATORY ONLY.								
TPV	TRAP PRIMER VALVE - PRECISION PLUMBING PRODUCTS PR-500 WITH 1/2" COPPER LINE. PROVIDE DISTRIBUTION UNIT TO SERVE TWO FLOOR DRAINS WHERE NECESSARY.								
WH	FREEZELESS WALL HYDRANT - WOODFORD MODEL B65. PROVIDE WITH OPERATING ROD SUITABLE FOR WALL THICKNESS AT INSTALLATION LOCATION.								
WHA-"X"	SHOCK ABSORBER, JOSAM SERIES 75000-S. MODEL NUMBER P.D.I. FIXTURE UNITS	75000-S AA 1	75001-S A 1-11	75002-S B 12-32	75003-S C 33-60	75004-S D 61-113			

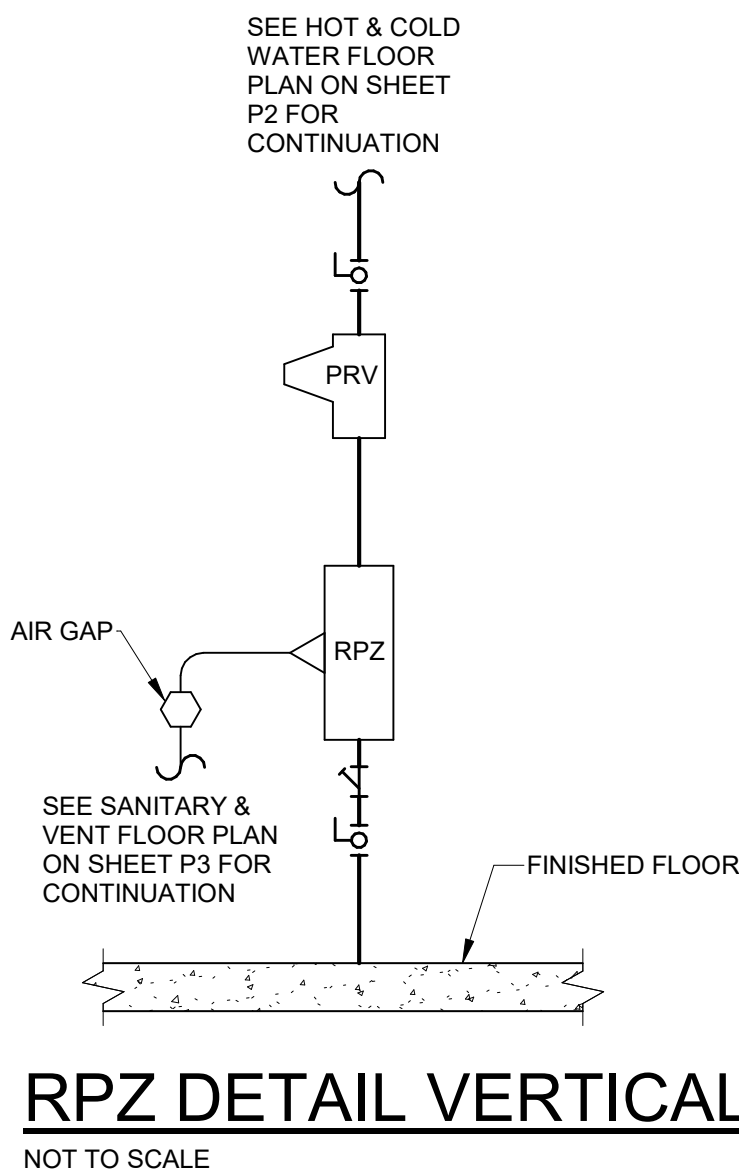
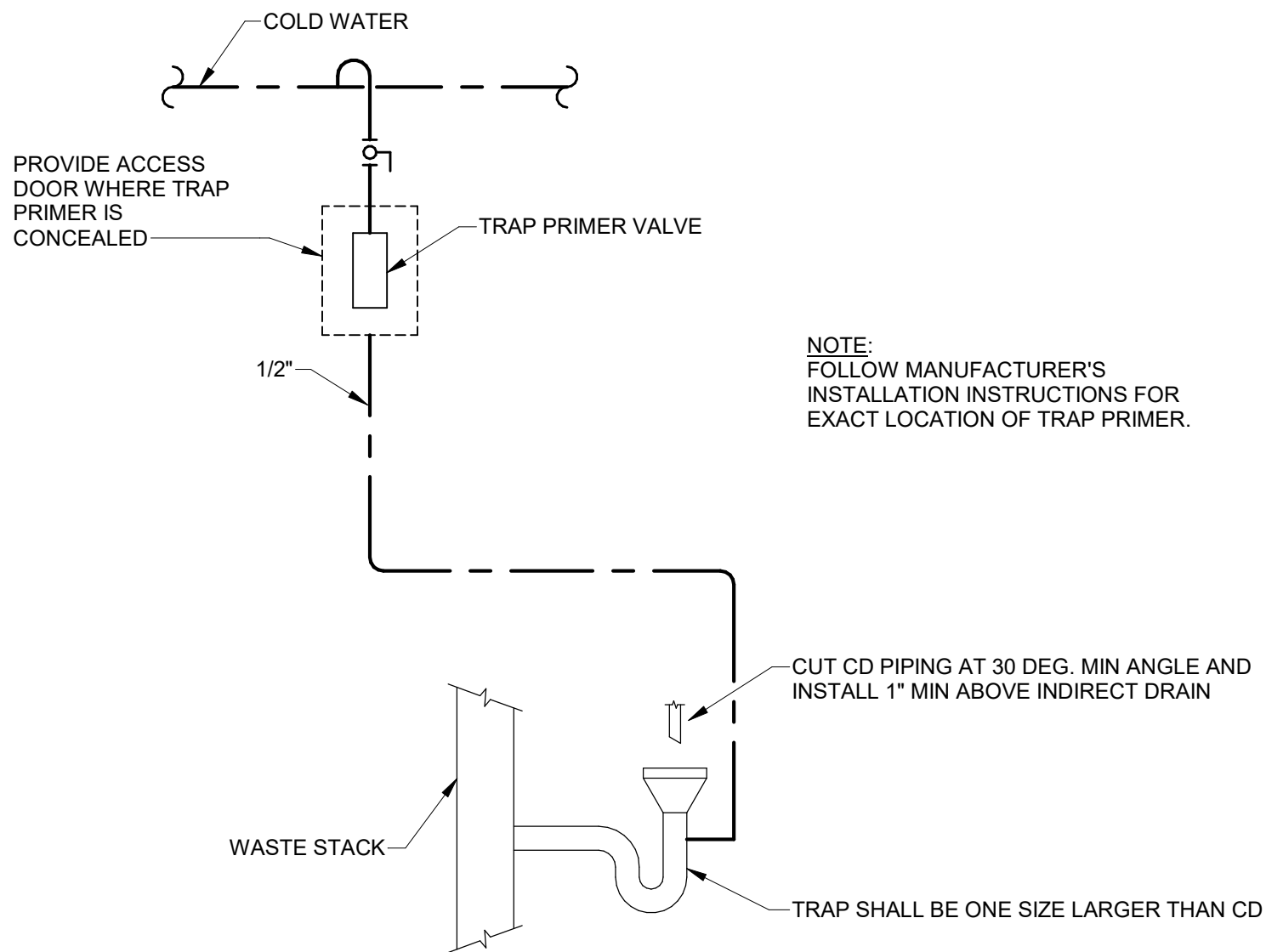

PLUMBING FIXTURE SCHEDULE										
DESIGNATION	FIXTURE	MANUFACTURER & MODEL	SIZE	SUPPLY FITTINGS AND STOPS	TRAP	CARRIER	REMARKS & ACCESSORIES	CONNECTION SIZES		
								WASTE	HOT	COLD
P-1	WATER CLOSET	AMERICAN STANDARD 3043.001	28 1/4" X 14" X 16 1/2" (ADA COMPLIANT)	--	INTEGRAL	FLOOR MOUNTED	FLUSH VALVE: SLOAN ROYAL MODEL FLUSHOMETER MODEL 111 WITH MANUAL FLUSH VALVE AND 1.6 GPF SEAT: AMERICAN STANDARD MODEL 5901.100	4"	-	1"
P-2	LAVATORY	AMERICAN STANDARD 0355.027	20 1/2" X 18 1/4" (ADA COMPLIANT)	3/8" ANGLE STOPS	1 1/2" 17 GA P-TRAP	WALL MOUNTED	FAUCET: MOEN COMMERCIAL MODEL 8425 ADA COMPLIANT FOR LEVER HANDLES. PROVIDE WITH HANGAR ARM CARRIER.	1 1/2"	1/2"	1/2"
P-3	JANITOR'S SINK	FIAT TSBC1610	24" X 12" X 12"	3/8" ANGLE STOPS	3" P-TRAP	FLOOR MOUNTED	FAUCET: T&S MODEL B-0665-BSTR (ADA COMPLIANT) WITH FIAT 830AA MOP SERVICE BASIN FITTING AND MODEL 832AA HOSE & HOSE BRACKET, STAINLESS STEEL MOP HANGAR & STAINLESS STEEL CAPS THRESHOLD.	3"	1/2"	1/2"
P-4	KITCHEN SINK	ELKAY ECTSRAD25226TBG	25" X 22" X 6" (ADA COMPLIANT)	3/8" ANGLE STOPS	1 1/2" 17 GA P-TRAP	COUNTER MOUNTED (DROP-IN)	FAUCET: ELKAY MODEL LKAV2061 DRAINS & STRAINERS: ELKAY LKDD ADA COMPLIANT FOR LEVER HANDLES.	1 1/2"	1/2"	1/2"

LEGEND

---	DOMESTIC COLD WATER
---	DOMESTIC HOT WATER
---	DOMESTIC HOT WATER RETURN
---	SANITARY SEWER
---	VENT
---	PIPE DOWN
---	PIPE UP
---	BALL VALVE
---	CHECK VALVE
---	UNION OR FLANGE
---	STRAINER
---	PLUMBING PLAN NOTE
---	CALLOUT HEAD

ABBREVIATIONS

ABV	ABOVE
AFF	ABOVE FINISHED FLOOR
ASJ	ALL SERVICE JACKET
CLG	CEILING
CO	CLEANOUT
CS	CIRCUIT SETTER
CV	CHECK VALVE
CW	DOMESTIC COLD WATER
DEG. F	DEGREES FAHRENHEIT
DN	DOWN
EW	ELECTRIC WATER HEATER
FD	FLOOR DRAIN
FR	FROM
FSK	FOIL SCRIM KRAFT
GA	GAUGE
GND	GROUND
GPH	GALLONS PER HOUR
GPM	GALLONS PER MINUTE
HB	HOSE BIBB
HP	HORSEPOWER
HW	DOMESTIC HOT WATER
HWR	DOMESTIC HOT WATER RETURN
LVG	LEAVING
MAX	MAXIMUM
MFR	MANUFACTURER
MIN	MINIMUM
NG	NATURAL GAS
NTS	NOT TO SCALE
OPG	OPENING
PDI	PLUMBING & DRAINAGE INSTITUTE
SAN	SANITARY SEWER
VTR	VENT THROUGH ROOF
W	WITH
WH	WALL HYDRANT
WHA	WATER HAMMER ARRESTOR
WRT	WROUGHT

GENERAL NOTES

- INSTALLATION SHALL BE IN STRICT ACCORDANCE WITH THE UNIFORM STATEWIDE BUILDING CODE, INCLUDING REFERENCED CODES AND STANDARDS AND IN ACCORDANCE WITH MANDATES OF THE LOCAL BUILDING OFFICIALS.
- THE GENERAL ARRANGEMENT AND LOCATIONS OF PIPING, FIXTURES, ETC. ARE INDICATED BY THE DRAWINGS AND SHALL BE INSTALLED IN ACCORDANCE THEREWITH, WITH THE EXCEPTION OF SUCH CHANGES AS MAY BE REQUIRED ON ACCOUNT OF OTHER TRADES. CONTRACTOR SHALL COORDINATE WORK WITH INSTALLATION OF OTHER SUBCONTRACTORS.
- PLUMBING WORK SHALL BE COORDINATED WITH THE CONTRACTOR AS TO SCHEDULING, DIMENSIONING AND LOCATION OF EQUIPMENT.
- MAJOR ITEMS ARE SHOWN ON THE PLANS. THE CONTRACTOR SHALL BE RESPONSIBLE FOR ALL INCIDENTAL ITEMS REQUIRED TO PROVIDE A COMPLETE AND FUNCTIONAL SYSTEM.
- SUBSTITUTION FOR SPECIFIED ITEMS SHALL BE BORNE BY THE CONTRACTOR.
- ALL REQUIRED WALL OR FLOOR OPENINGS SHALL BE COORDINATED WITH THE CONTRACTOR.
- ALL PIPING SHALL BE ABOVE CEILING UNLESS INDICATED OTHERWISE.
- ALL EQUIPMENT SHALL BE WIPED CLEAN, REMOVING ALL TRACES OF OIL, DIRT, OR PAINT SPOTS.
- PROVIDE SUPPORTS TO RIGIDLY ATTACH ALL EQUIPMENT, APPURTENANCES AND PIPE AS REQUIRED FOR SUPPORT. PRIOR TO INSTALLATION OF HANGERS AND INSERTS, THE CONTRACTOR SHALL COORDINATE LOCATIONS AND EQUIPMENT TO MINIMIZE CONFLICTS WITH OTHER BUILDING SYSTEMS.
- CONTRACTOR SHALL MAKE FINAL CONNECTIONS TO ALL EQUIPMENT INDICATED TO BE FURNISHED BY OTHERS.
- ALL PIPE OF THE SAME SIZE SHALL BE OF THE SAME MATERIAL.
- SLOPE ALL DRAIN LINES 1/4 INCH PER FOOT MINIMUM FOR SIZES LESS THAN 4 INCHES. SLOPE 1/8 INCH PER FOOT SIZES 4 INCHES AND LARGER UNLESS INDICATED OTHERWISE BY INVERTS ON DWGS.
- SOIL, WASTE AND VENT PIPING LOCATED BELOW GRADE SHALL BE MINIMUM 2 INCHES.
- VENTS SHALL EXTEND 12 INCHES ABOVE ROOF. ROOF FLASHING SHALL BE COORDINATED BY THE CONTRACTOR.
- DOMESTIC HOT AND COLD WATER PIPING SHALL BE 1/2 INCH SIZE UNLESS INDICATED OTHERWISE.
- BALL VALVES SHALL BE USED IN LIEU OF GATE VALVES 2 INCHES OR SMALLER.
- ALL EXPOSED FIXTURE SUPPLIES AND WASTE LINES SHALL BE CHROME PLATED.



ARCHITECTURAL PARTNERS

10 9th Street
Lynchburg, Virginia 24504
phone: 434-846-8456
fax: 434-846-4534
architecturalpartners.com

BOTETOURT COUNTY
RMFDE - 911 COMPLEX

PROJECT NO.: 24100

43 EASTPARK DRIVE, ROANOKE, VA 24019

BID SET

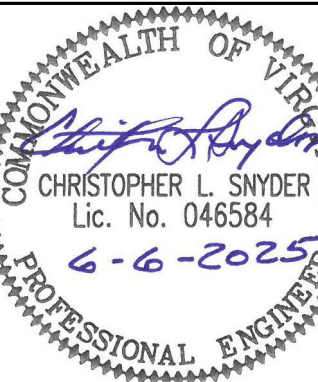

WRITTEN DIMENSIONS ON THESE DRAWINGS SHALL TAKE PRECEDENCE OVER SCALED DIMENSIONS. CONTRACTORS SHALL VERIFY AND BE RESPONSIBLE FOR ALL DIMENSIONS AND CONDITIONS ON THE JOB, AND THIS OFFICE MUST BE NOTIFIED OF ANY VARIATION FROM THE DIMENSIONS AND CONDITIONS SHOWN BY THESE DRAWINGS.

DATE: 2025-06-06
DESIGNED: CLS/ETO
DRAWN: ETO
CHECKED: CLS
REVISIONS:

PLUMBING
LEGEND,
NOTES,
SCHEDULES,
DETAILS &
ABBREVIATIONS

P1



MASTER
ENGINEERS & DESIGNERS
904 Lakeside Drive, Lynchburg VA 24501
434-846-1350 Fax: 434-846-1351

RS

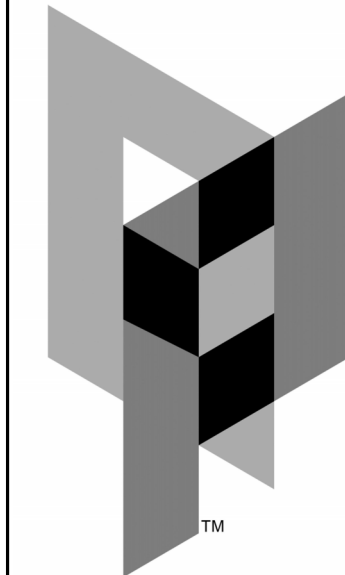

ARCHITECTURAL
PARTNERS

10 9th Street
Lynchburg, Virginia 24504
phone: 434-846-8456
fax: 434-846-4534
architecturalpartners.com

BOTETOURT COUNTY
RMFDE - 911 COMPLEX
43 EASTPARK DRIVE, ROANOKE, VA 24019 PROJECT NO.: 24100

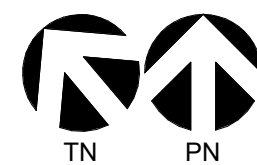
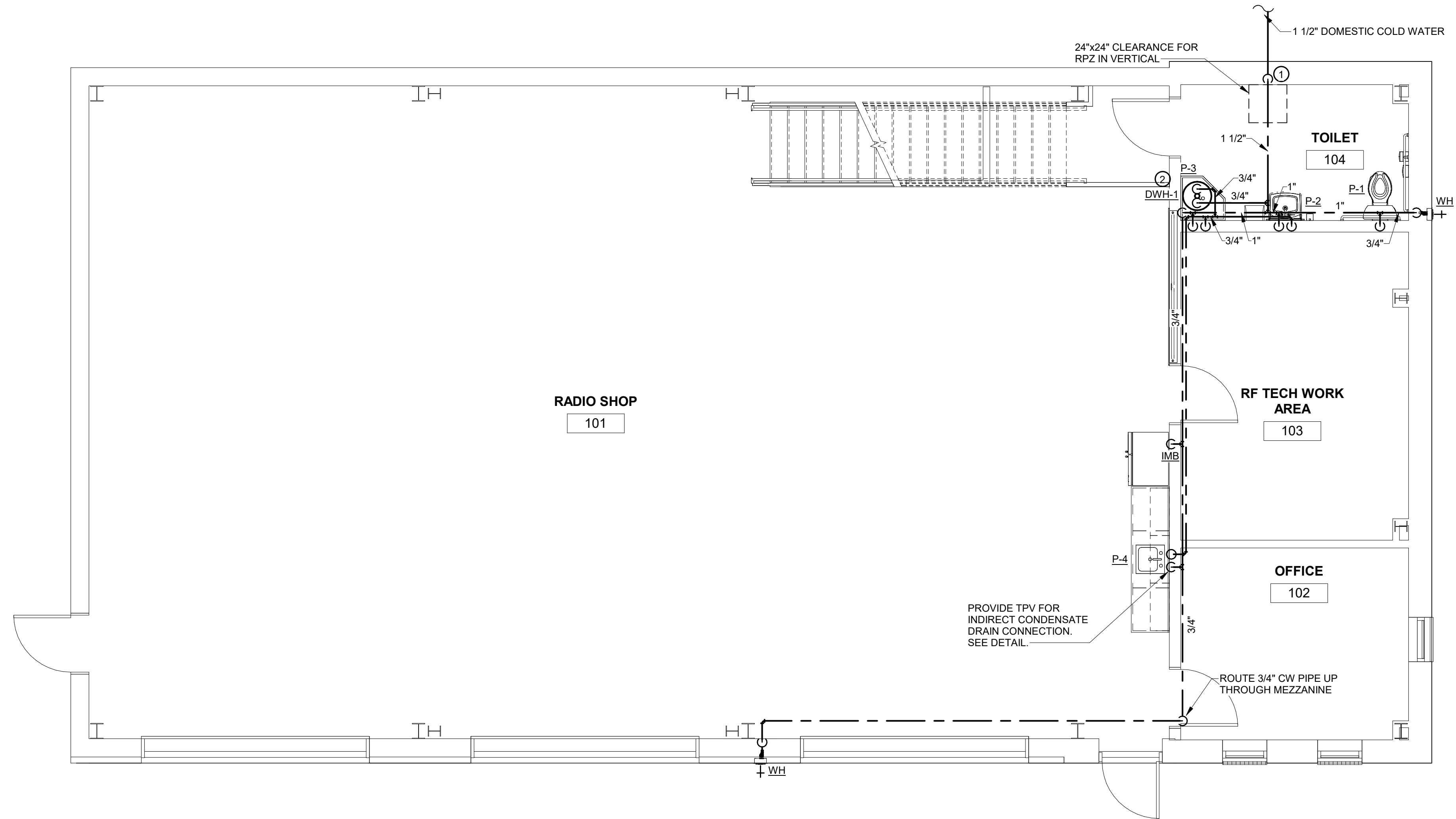

1
P2

PLUMBING FIRST FLOOR HOT & COLD WATER PLAN

1/4" = 1'-0"

PLAN NOTES

- PROVIDE 1 1/2" RPZ IN VERTICAL. ROUTE RPZ DRAIN THROUGH WALL.
- MOUNT DWH-1 ABOVE P-3 ON SUPPORT SHELF. SEE DOMESTIC WATER HEATER MOUNTING DETAIL ON SHEET P0.1.

BID SET

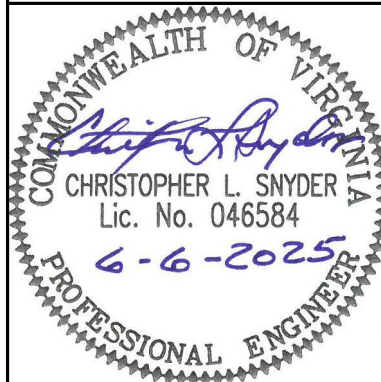

WRITTEN DIMENSIONS ON THESE DRAWINGS SHALL TAKE PRECEDENCE OVER SCALED DIMENSIONS. CONTRACTORS SHALL VERIFY AND BE RESPONSIBLE FOR ALL DIMENSIONS AND CONDITIONS ON THE JOB AND THIS OFFICE MUST BE NOTIFIED OF ANY VARIATION FROM THE DIMENSIONS AND CONDITIONS SHOWN BY THESE DRAWINGS.

DATE: 2025-06-06
DESIGNED: CLS
DRAWN: ETO
CHECKED: CLS
REVISIONS:

PLUMBING
FIRST FLOOR
HOT & COLD
WATER
PLANS

P2

1/4" = 1'-0"

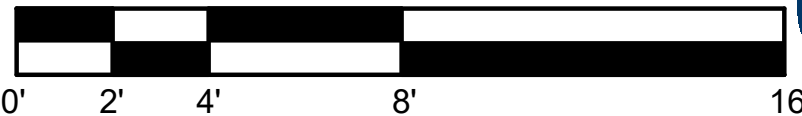

MASTER
ENGINEERS & DESIGNERS
904 Lakeside Drive, Lynchburg VA 24501
434-846-1350 Fax: 434-846-1351

RS

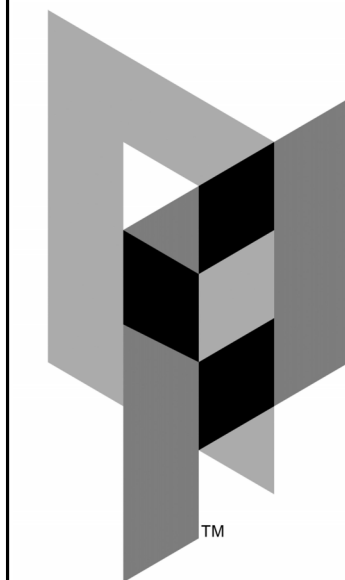

ARCHITECTURAL
PARTNERS

10 9th Street
Lynchburg, Virginia 24504
phone: 434-846-8456
fax: 434-846-4534
architecturalpartners.com

BOTETOURT COUNTY
RMFDE - 911 COMPLEX
43 EASTPARK DRIVE, ROANOKE, VA 24019 PROJECT NO.: 24100

BID SET

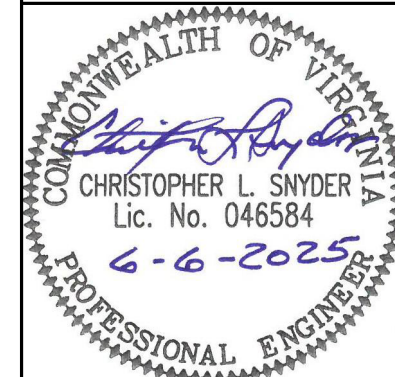

WRITTEN DIMENSIONS ON THESE DRAWINGS SHALL TAKE PRECEDENCE OVER SCALED DIMENSIONS. CONTRACTORS SHALL VERIFY AND BE RESPONSIBLE FOR ALL DIMENSIONS AND CONDITIONS ON THE JOB AND THIS OFFICE MUST BE NOTIFIED OF ANY VARIATION FROM THE DIMENSIONS AND CONDITIONS SHOWN BY THESE DRAWINGS.

DATE: 2025-06-06
DESIGNED: CLS/ETO
DRAWN: ETO
CHECKED: CLS
REVISIONS:

PLUMBING
FIRST FLOOR
& MEZZANINE
SANITARY &
VENT PLANS

RS

P3

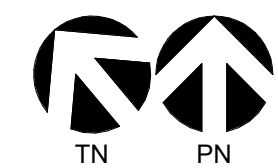
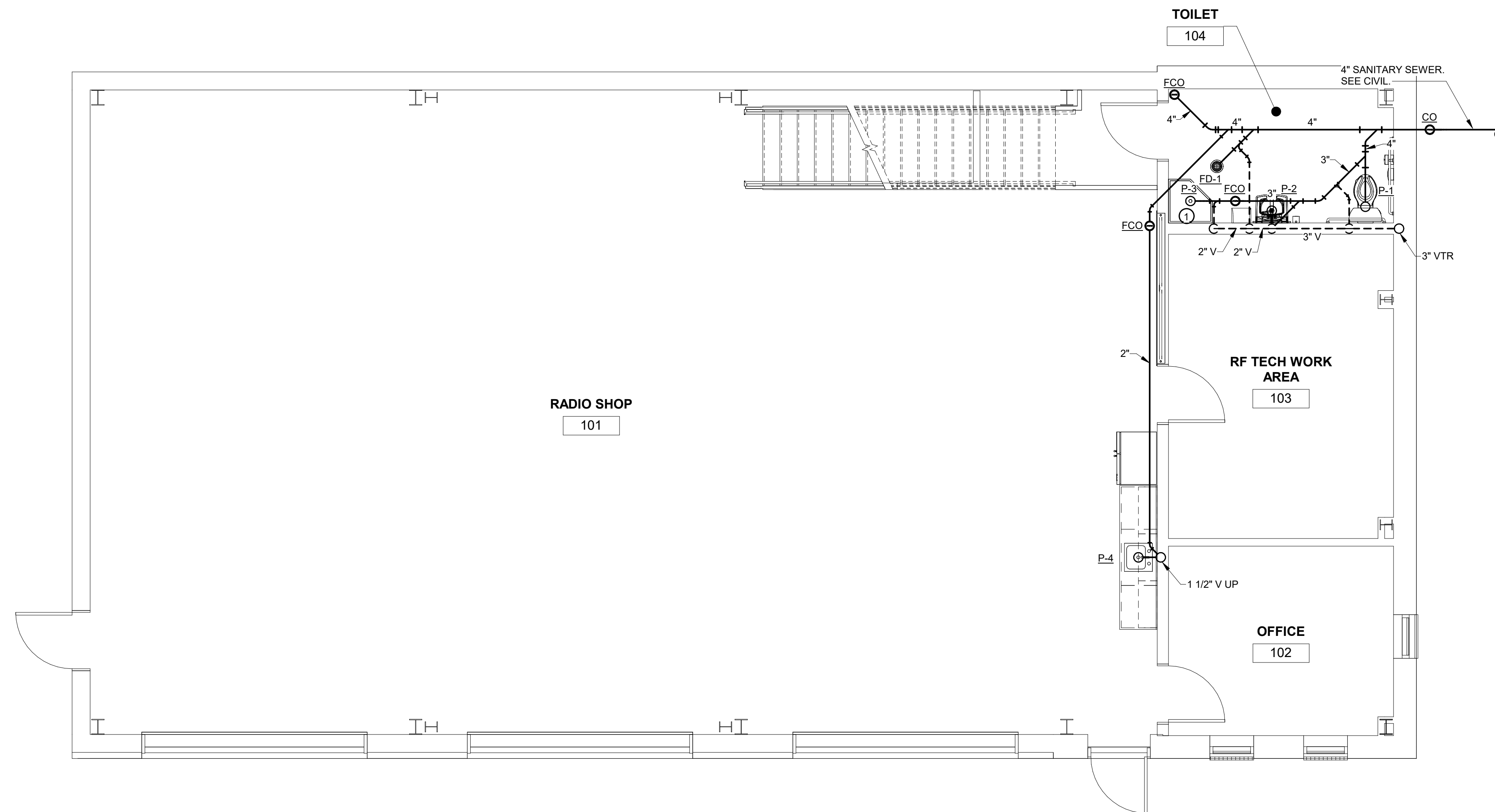

1 PLUMBING FIRST FLOOR SANITARY & VENT PLAN
P3 1/4" = 1'-0"

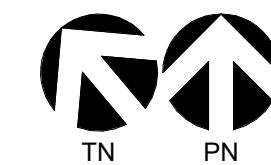

2 PLUMBING MEZZANINE SANITARY & VENT PLAN
P3 1/4" = 1'-0"

PLAN NOTES

- ROUTE CONDENSATE FROM DWH-1 ABOVE AND TIE INTO JANITOR'S SINK BY INDIRECT DRAIN.
- ROUTE CONDENSATE FROM F-1 TO 1 1/2" V SERVING P-4.



MASTER
ENGINEERS & DESIGNERS
904 Lakeside Drive, Lynchburg VA 24501
434-846-1350 Fax: 434-846-1351

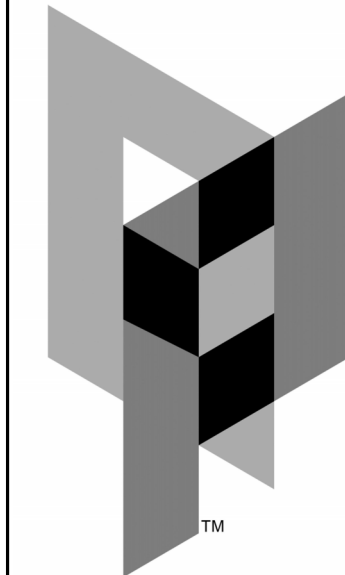

ARCHITECTURAL
PARTNERS

10 9th Street
Lynchburg, Virginia 24504
phone: 434-846-8456
fax: 434-846-4534
architecturalpartners.com

BOTETOURT COUNTY
RMFDE - 911 COMPLEX
43 EASTPARK DRIVE, ROANOKE, VA 24019 PROJECT NO.: 24100

BID SET

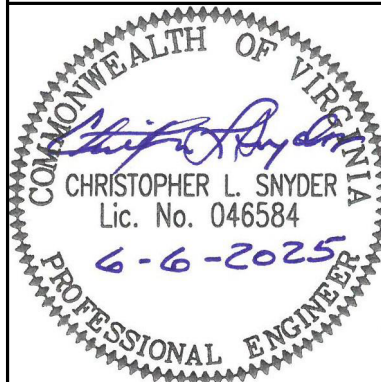

WRITTEN DIMENSIONS ON THESE DRAWINGS
SHALL TAKE PRECEDENCE OVER SCALED
DIMENSIONS. CONTRACTORS SHALL VERIFY
AND BE RESPONSIBLE FOR ALL
DIMENSIONS AND CONDITIONS ON THE JOB
AND THIS OFFICE MUST BE NOTIFIED OF
ANY VARIATION FROM THE DIMENSIONS AND
CONDITIONS SHOWN BY THESE DRAWINGS.

DATE: 2025-06-06
DESIGNED: CLS/ETO
DRAWN: ETO
CHECKED: CLS
REVISIONS:

PLUMBING
FIRST FLOOR
& MEZZANINE
NATURAL
GAS PLANS

RS P4



904 Lakeside Drive, Lynchburg VA 24501
434-846-1350 Fax: 434-846-1351

423-315

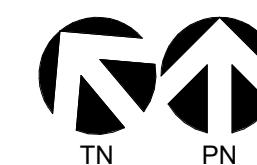

2
P4

PLUMBING MEZZANINE NATURAL GAS PLAN
1/4" = 1'-0"

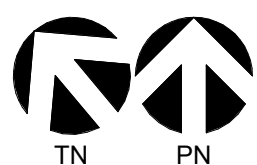
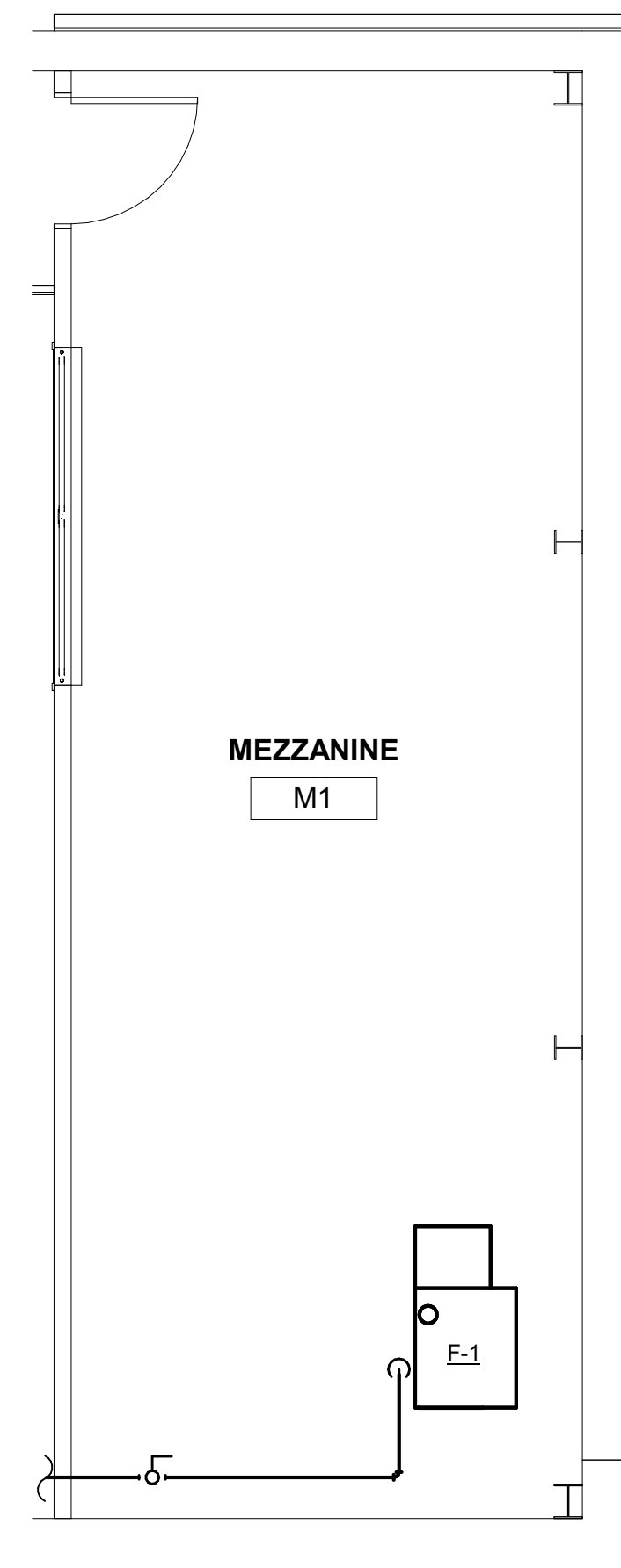

1
P4

PLUMBING FIRST FLOOR NATURAL GAS PLAN
1/4" = 1'-0"

